



Simply Enjoy Water

Pool lighting

BRIO WM50

LED Lamp

for standard pool niche



Environmentally friendly

Sustainable energy

No more bulb lamps

The European Union has decided to eliminate traditional lamps by September 1st 2012. The EU Directives are planning to remove lamps above than 100W from 2009 on.

85% energy saved

Replacing your bulb lamp with a WM50 lamp lets you divide your electrical power consumption by 6.

Reduction in CO² emissions

Invest in efficient and durable lighting

3400 lumens Scattering angle 120°
Powerful lighting

WM50 includes all essential elements for ensuring the best lighting for your pool; with a clear white light, a market-exclusive power of 3400 lumens and a wide scattering angle of 120°. **Water is even clearer with this lighting !**

Durable and high performance lighting 30.000 hour lifespan

The disposable era is over ! The lighting quality of WM50, which is made up of high power LEDs, is guaranteed even after tens of thousands of hours of operation. No more breakdowns or heavy duty maintenance to change your pool lamp !

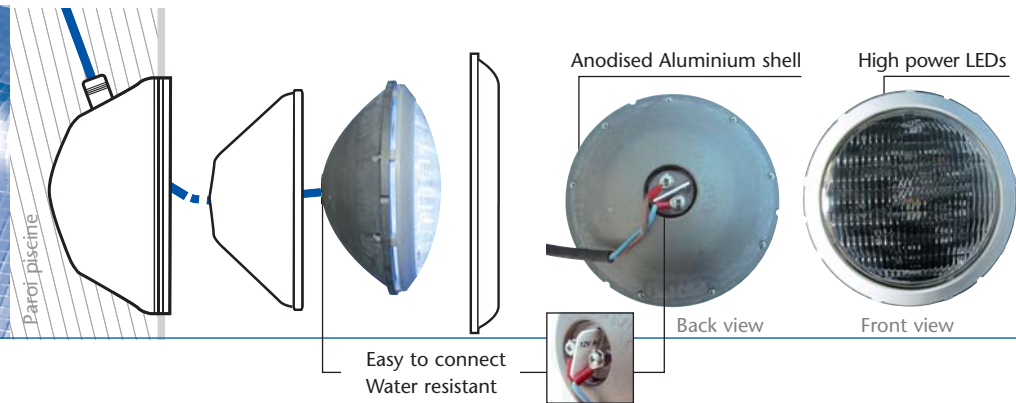
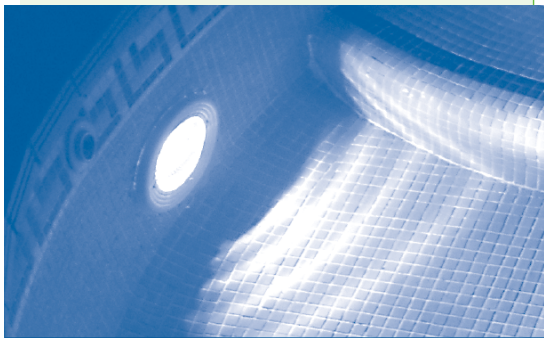

Reference	WM50W
Power consumed	50 W
Number of LEDs	12 LEDs
Lighting	bright white light
White luminous flux (lumen)	3400 lm
Lifespan	30 000 h
Watertight enclosure	IP-68
Dimensions	PAR-56



Easy to change bulb !

No special work needed on an existing installation

For replacing the current system :

WM50 is installed in all PAR56 lamps instead of your bulb lamp.

Because of its low power consumption, it is possible to use it intensively without risk of overheating the transformer and it solves all voltage drop problems (lighting too weak, inconvenient stoppagings, etc.)

When installing for the first time, WM50 needs cross-sections of cables to be 6 times less, which facilitates installing wires and saves money.

BRIO WM50 : The best alternative to bulb lamps

BRIO WM50



LED lamp

Choose your new pool lighting

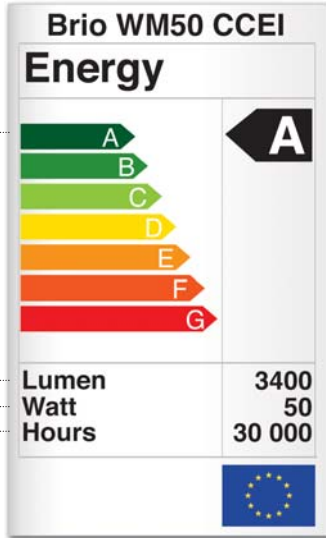

Energy Efficiency and European standards

How do I read the EU Energy Label of a lamp?

The power efficiency of a lamp is evaluated using a grade that changes from A (optimal efficiency) to G (poor efficiency). This performance corresponds to the ratio between the luminous flow (lm) and the power consumed (W). It is expressed in lumens per Watt (lm/W). To reach class A, your lamp should have an efficiency higher than 50 lm/W. Your lamp should have an energy efficiency higher than 50 lm/W in order to reach class A. With 68 lm/W, WM50 guarantees optimal efficiency !

Does my current pool lighting comply with standards ?

Yes, but not for long. The European Directives Union is planning to remove bulb lamps greater than 100W from 2009 on. Traditional bulbs that do not belong to class A will soon be prohibited in Europe.

Efficiency and powerful lighting

Does the number of LEDs affect the lighting power ?

The powerful lamp lighting with mini-LEDs rarely goes over 500 Lumens, no matter how many LEDs are used (500 or more per lamp). As well as this, their poor power yield excludes them from class A.

What is the ideal luminous flux for lighting my pool ?

40 to 60 lumens per m³, i.e. around 3000 lumens for a 50m³ pool. Luminous flux is expressed in lumens and it measures the lighting power of a lamp.

Demand high power LEDs

for all of your LED lighting systems!

Reducing costs and saving energy

How long does an LED lamp last?

An LED lasts for 100 000 hours. However, an LED lamp is made up of many other electronic components that do not last as long.

The overheating control is the key to the longevity of LED lamps. The aluminium design of the WM50 optimises thermal exchanges, which ensures a lifespan of 30 000 hours; 30 times greater than a bulb lamp.

How can I reduce my power consumption costs?

By using an LED bulb for your pool lights, you save 85% of your power consumption.

Comparison*	Traditional 300W bulb	BRIO LED WM50
Purchase + Installation for 2 floodlights	621 € 1 600VA transformer 50m of 16 ² cable	841 € 1 100VA transformer 50m of 2,5 ² cable
Power consumption 0,135 €/kWh	2430 € 18 000 kWh	405 € 3 000 kWh
Replacement Maintenance	1200 € 2 new bulbs every 1000 hours	0 € Lifespan : 30 000 hours

Total savings
3000 €
15 000 kWh

*comparison based on the lifespan of a WM50 lamp (30,000 hours), for a pool equipped with 2 lights

You create an optimal lighting effect so that you can fully enjoy evenings spent around your pool. You will benefit from night swims in clear water.

